

DSD HOOKUP ENDOSCOPE CONNECTORS (Figure 1)

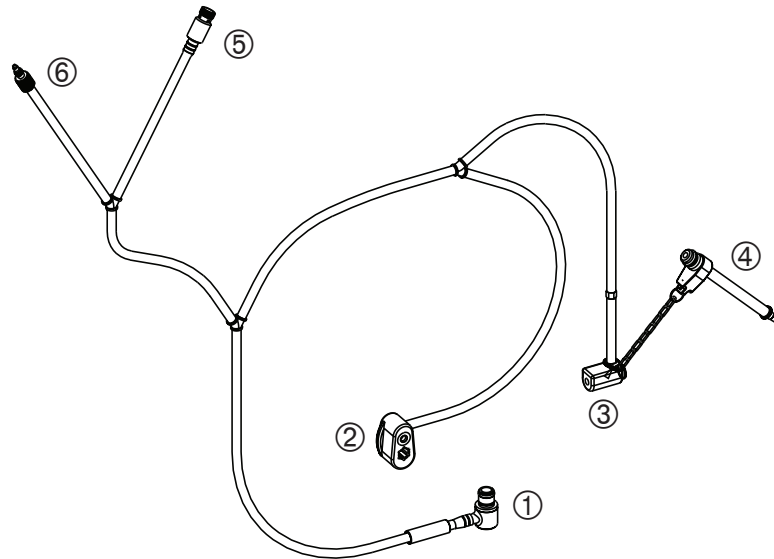

①	Basin Connector (see Basin Connection Instructions on pg 2)	④	Air/Water Plug
②	Air Probe Connector	⑤	Gas Connector
③	Suction Connector	⑥	Auxiliary Water Connector

ADDITIONAL REQUIRED ENDOSCOPE CONNECTIONS

Leak Test Hookup
PN DSD-110-HU0102

For Medivators AERs with leak test capability. (see Basin Connection Instructions on page 2)

Channel Plug
PN CLM-110-HU0108

B3, B4 not needed
May also use Olympus MH-944

Locate the endoscope port* and follow the instructions for attaching the corresponding Endoscope Connector. All connectors must be attached.

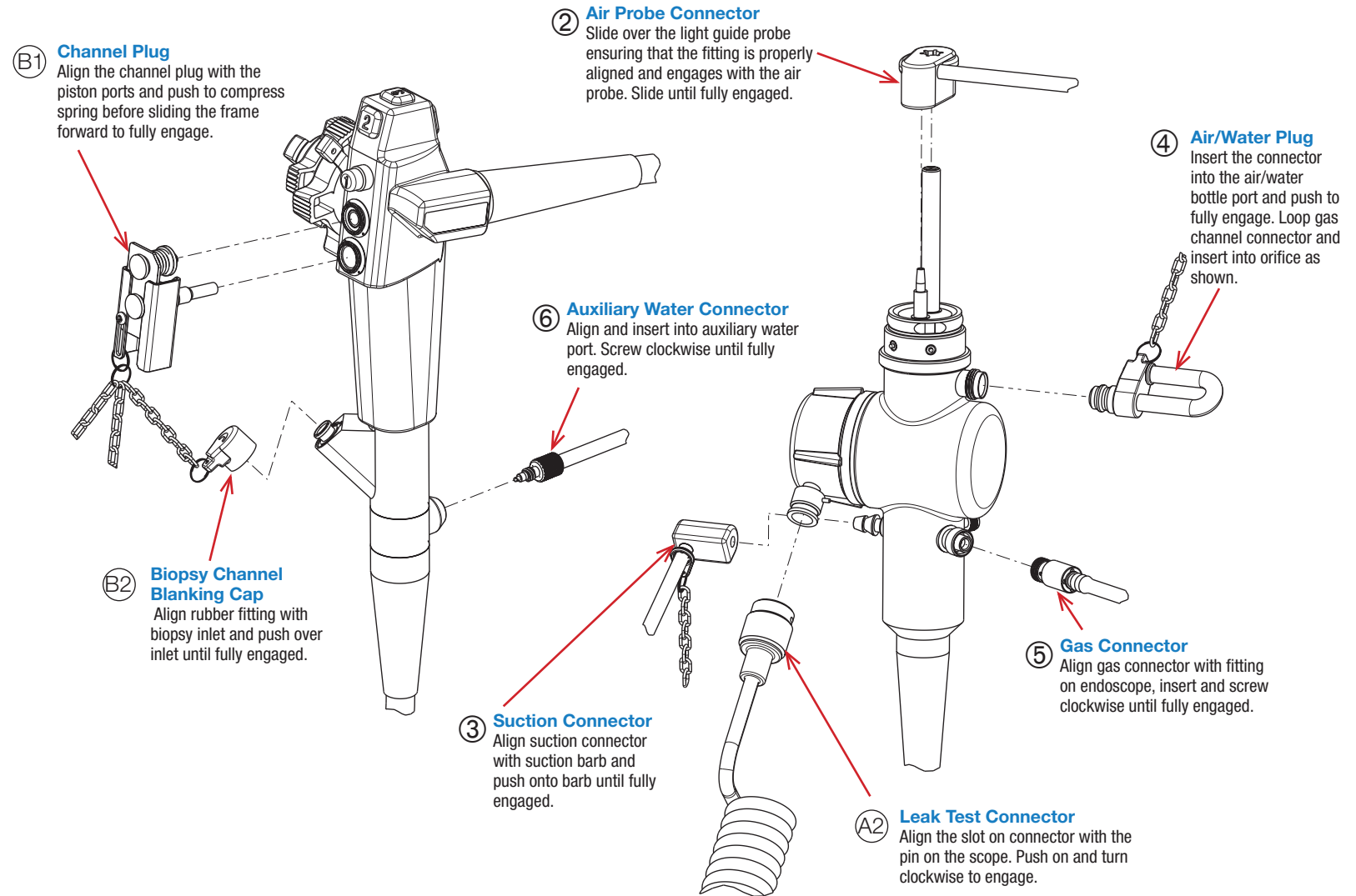

* Representative endoscope for illustrative purposes only. For exact port locations, refer to endoscope manufacturer's instruction guide.

! Ensure proper alignment of all connectors with the endoscope mating parts prior to attachment.

If you have any questions regarding this hookup, in the U.S., please contact Medivators Technical Support at 1-800-444-4729. Outside the U.S., please contact your local Minntech Distributor.

DSD HOOKUPS

DSD Hookups are the interface between the Medivators DSD and SSD Series Automated Endoscope Reprocessors (AERs) and the endoscope, to ensure correct connectivity and flow rates per manufacturer's specifications.

LEAK TEST HOOKUPS

The Leak Test Hookup connects the endoscope's leak test port to the DSD/SSD Basin Leak Test Connector for leakage detection in the endoscope. Minntech recommends the use of the leak test feature in AERs with the leak test capability during the reprocessing cycle.

The Leak Test Hookup will always be used in conjunction with a DSD Hookup. For endoscopes with channels, please refer to the online hookup guide for the appropriate DSD Hookup. For endoscopes without channels, hookup DSD-110-HU0122 must always be used.

Leak Test Hookups are endoscope manufacturer specific. One leak test hookup is supplied per each endoscope basin based on individual facility endoscope inventory. Leak test hookups are also sold separately.

Medivators DSD/SSD automated endoscope reprocessors with leak test capability include: DSD-201LT, DSD EDGE, SSD-102LT.

DSD/SSD BASIN CONNECTION INSTRUCTIONS

DSD Hookup Insert the DSD Hookup quick connect fitting into the AER by inserting into the Basin Endoscope Hookup Connector, and push down until the fitting clicks into place.

Leak Test Hookup Insert the Leak Test Hookup quick connect fitting into the Basin Leak Test Connector and push until fitting clicks into place. See figure 2.

Basin Endoscope Hookup Connector

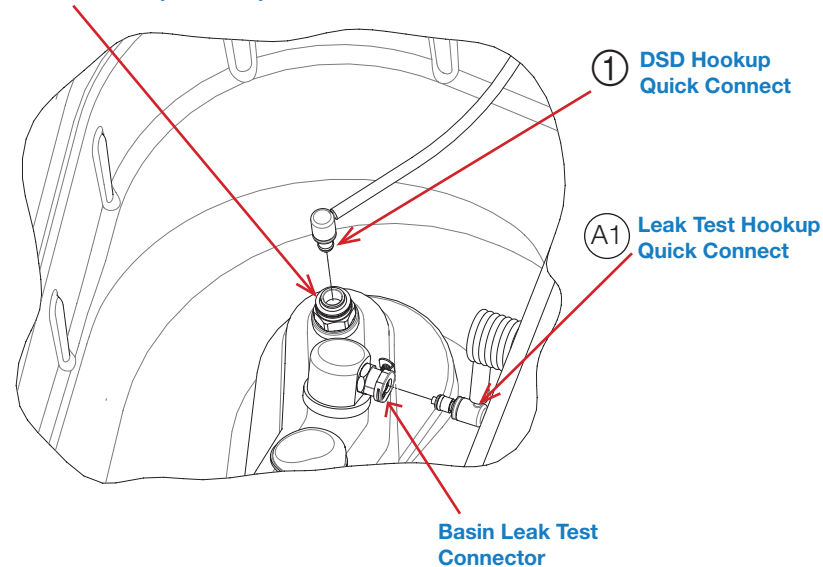

Figure 2

CLEANING ADAPTERS AND CHANNEL PLUGS

For some endoscope models, endoscope manufacturer and model-specific cleaning adapter(s) and/or channel plugs may be required to prepare the endoscope for reprocessing. Minntech manufactures some Medivators cleaning adapters and/or channel plugs specific to each endoscope manufacturer and model(s). The requirement for these additional adapter(s) will be noted in the online hookup guide. Where Minntech does not manufacture or supply these adapters, reference will be made to the use of adapters from the endoscope manufacturer's manual cleaning kit supplied with the endoscope.

DESIGNATED HOOKUP FOR THE FOLLOWING ENDOSCOPES*:

Olympus®	CF-1T100I
Olympus®	CF-1T100L
Olympus®	CF-100HI
Olympus®	CF-100HL
Olympus®	CF-100I
Olympus®	CF-100L
Olympus®	CF-100S
Olympus®	CF-100TI
Olympus®	CF-100TL
Olympus®	CF-130I
Olympus®	CF-130L
Olympus®	CF-130S
Olympus®	PCF-100
Olympus®	PCF-130I
Olympus®	PCF-130L

* This list of corresponding endoscope models is subject to change without notice. For a full list, please go to:

www.minntech.com/medivators/hookuplookup

WARNINGS & CAUTIONS



This hookup is intended for connection only with the specific endoscope models identified in the appropriate Medivators online hookup guide. Use of this hookup with endoscopes other than those specified by the on line hookup guide may result in inadequate HLD.

Users operating Medivators AERs and hookups must be trained and competent in the understanding of endoscope channel systems.

Prior to reprocessing, users must verify that the hookup used contains connections for all appropriate channels that require a separate reprocessing connection according to the hookup instructions.

All connectors and adapters must remain firmly attached and unrestricted for the entire disinfection cycle to ensure adequate HLD. Users must inspect the endoscope and hookup combination to verify proper connection and flow.

Modifications or repairs to hookups which do not correspond to the manufacturer's specifications may result in inadequate HLD and/or damage to endoscopes.

Failure to properly clean and prepare endoscope for immersion prior to hookup connection may result in inadequate HLD and/or damage to the endoscope.

Ensure proper alignment of all connectors with the endoscope mating parts prior to attachment. Misalignment may cause damage to hookup components and/or endoscope mating parts.

Endoscopes must be inspected for damage and verified to be in proper working order prior to hookup connection. Connection of hookups to damaged endoscopes or endoscopes with obstructed/restricted channels could result in inadequate HLD.

Manual leak testing must be carried out in accordance with manufacturer's recommendations prior to reprocessing.

Install all necessary waterproof caps, plugs and cleaning adapters prior to immersion.

Do NOT autoclave Medivators hookups.

Minntech makes no claim on high-level disinfection efficacy when these reprocessing instructions are not followed, or when this hookup kit is applied to endoscopes other than those specified in the online interactive hookup guide.

Avoid biological contamination. Always wear personal protective equipment when handling endoscopes.



Manufactured in the USA by:

MINNTECH
A Cantel Medical Company

Minntech Corporation
14605 28th Avenue North
Minneapolis MN 55447 USA
Phone: 763.553.3300
Toll Free: 800.328.3340
Fax: 763.553.3387
Web: www.minntech.com

Minntech Asia / Pacific Pte Ltd
1A International Business Park
#05-01 Singapore 609933
Phone: +65 6227 9698
Fax: +65 6225 6848

Minntech BV
Sourethweg 11
6422PC Heerlen
The Netherlands
Phone: +31 45 5 471 471
Fax: +31 45 5 429 695
email: info@minntechbv.com



Minntech Beijing Representative Office
Room 708, 7th Floor Kaiheng Center,
No. 2 Chaoyangmennei Street
Dongcheng District, Beijing China, 100010
Phone: +8610 6567 8446
Fax: +8610 6567 8445